



**FX380RC Issue 3**  
**Xenon 2 Kw - Remote**  
**Control, Variable Speed**

**APPLICATION**

The new FRANCIS FX Premium range of variable speed Remote Controlled Searchlights incorporate the design features required to successfully operate searchlights in the most demanding product operating environments on land and sea.

Francis Searchlights have redesigned and improved the remote controlled Xenon Searchlight still further by adding full variable speed as a standard option at no extra cost. With the "colour temperature" of the Xenon lamp being equal to that of "sunlight" the searchlight is ideal for spotting dangers to navigation in the Polar Regions, such as low-lying icebergs. Other potential hazards, such as debris and small craft, are easily spotted at long range allowing sufficient time for action to be taken.

**SPECIFICATION**

- Immediate full lamp brilliance from switch on.
- Instant re-strike. No "cooling" down time required.
- Toughened front glass.
- Parabolic reflector, electro-formed nickel rhodium plated.
- Economical 3000 hour lamp life. Lamp Part no. D20195
- Constructed from marine grade materials & fixings.
- Stove enamel paint finish.
- Remote pan rotation 385°.
- Remote elevation control ±25°.
- Variable speed joystick control panel supplied.
- Variable Rotation Speed 1 to 20°/sec (Pan)
- Variable Elevation Speed 1 to 10°/sec (Tilt).
- Operational temperature -50°C.
- Adjustable lamp focus, 1.5° spot to 10° flood.
- Remote focus fitted as standard.
- Well proven and reliable power supply unit suitable for 50 or 60 Hz 1ph power supplies.
- Sealing - IP66 Gearbox, IP56 Searchlight, IP20 PSU
- **Searchlight weight** 70 Kgs.
- **Power supply weight** 65.9 Kgs.
- **Range** 7485 metres.
- **Peak Beam Candle Power** 56 million.

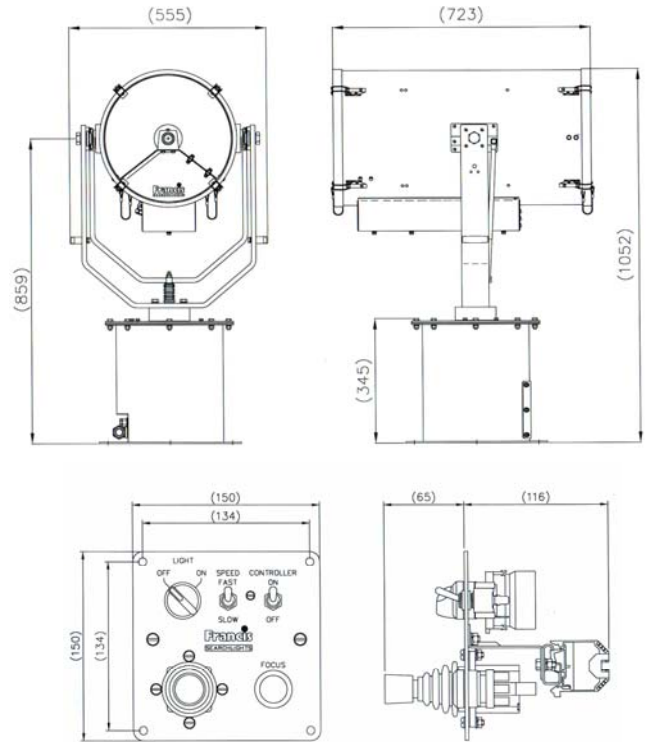

All dimensions in Millimeters

**BASE FIXING DETAILS:**  
 4 HOLES 12.5 DIA EQUI-SPACED  
 ON A 350mm PCD

**PSU DIMENSIONS:**  
 483 X 380 X 305MM  
 FIXINGS: 440 X 152MM

**Part Numbers**

Type	Supply	Watts	Part No
FX380RC	240v	2000w	A2469
FX380RC	110v	2000w	A2209

For more information contact:

**Francis Searchlights Limited**  
 Union Road, Bolton, BL2 2HJ, UK  
 Tel 44 (0) 1204 558960 Fax 44 (0) 1204 558979  
 Email sales@francis.co.uk Web site www.francis.co.uk