



- **Weight 2.01kgs.**
- **12v or 24v lamps.**
- **180mm (7") diameter light unit.**
- **Waterproof in accordance with FV2051 specification.**

Specifications

- These stem-fixed headlights are fitted with a 180mm (7") metal and glass light unit with replaceable lamps and are water proof in accordance with FV2051 specification.
- They can be supplied with either 12v or 24v lamps.
- The headlight can be mounted in any attitude, the light being re-positioned accordingly.
- Cable entry at the rear of the body is made through a standard military approved sealing cone and coupling nut.
- Pre-treatment and paint finish in accordance with MVEE 666 specification.
- Standard paint finish BS381c colour No. 224 deep bronze green.
- Weight 2.01kgs.
- Light units "e" marked where shown thus *.

Dimensions

A	B	C	D	E	Weight
Ø 201	Ø 175	141	92 Approx	84	2.01Kg

All dimensions in millimetres

1407 Series Headlights

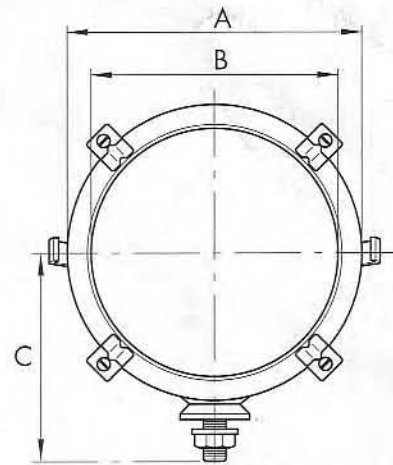

15.9mm (5/8") Fixing Bolt Diameter

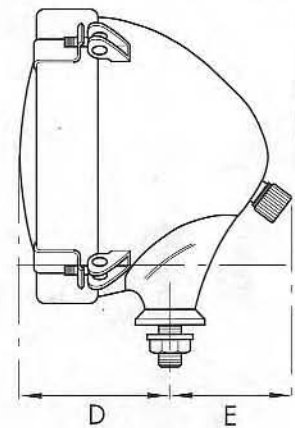

Product Information

Model	FV N ^o .	N ^o .	Mk.	NSN 6MT3-6220-99-	Lamp Volts (if fitted)	Watts	Type	Lamp Cap	Rule of Road and Dip Beam Direction	Francis Despatch N ^o .
1407-A	157970	2	1	910-9175	26	50/50	Tungsten	} BPF P36d	Vertical Dip	B7236
1407-B	157970	2	1	910-9175	12	44/38	Tungsten		Vertical Dip	B7868
1407-C	157970	2	1	910-9175	None	None	Tungsten		Vertical Dip	B7237
1407-G	426612	1	1	803-4202	24	50/50	Tungsten	} P45	Vertical Dip	B7871
1407-H	426612	1	1	803-4202	12	44/38	Tungsten		Vertical Dip	B7872
1407-J	426612	1	1	803-4202	None	None	Tungsten		Vertical Dip	B7238
1407-N	817189	2	4	835-0421	24	55/50	Tungsten	P45	*Right Hand	B7239
1407-O	817243	2	5	835-0423	12	60/55	T. Halogen	} P43t (H4)	*Left Hand	B7253
1407-P	817243	2	5	835-0423	24	75/70	T. Halogen		*Left Hand	B7897
1407-Q	817244	2	6	835-0424	24	75/70	T. Halogen	P43t (H4)	*Right Hand	B7898
1407-R	939073	2	7	835-0422	24	55/50	Tungsten	} P45	*Left Hand	B7752
1407-S	939073	2	7	835-0422	12	45/40	Tungsten		*Left Hand	B7899